



Gray Road, Hednesford
Cannock, WS12 4HJ

£174,500

Hednesford

£174,500



Paul Carr Estate Agents are delighted to market this semi-detached, chain-free Bungalow near Pye Green in the heart of Cannock - providing excellent access to local amenities, transport links and schools.

This property briefly comprises an Entrance Porch, Central Hall, bay-fronted Lounge, Kitchen, Family Bathroom and double Bedroom leading to the rear garden.

Situated on a private plot, the property frontage features an imprinted concrete driveway with space for multiple vehicles. The private rear garden is primarily laid to lawn with slatted seating area and storage shed.





Property Specification

One Bedroom Bungalow
Spacious Bay-Fronted Lounge
Imprinted Concrete Driveway For Multiple Vehicles
Private Rear Garden
Excellent Commuting Links
No Chain

Entrance Porch

Hall

Kitchen

8' 11" x 6' 5" (2.72m x 1.95m)

Lounge

14' 6" x 11' 11" (4.41m x 3.62m)

Bedroom One

9' 11" x 11' 11" (3.01m x 3.62m)

Family Bathroom

5' 8" x 6' 5" (1.72m x 1.95m)

External

Agent's Note:

Every care has been taken with the preparation of these Sales Particulars but they are for general guidance only and complete accuracy cannot be guaranteed. If there is any point which is of particular importance, professional verification should be sought. The mention of any fixtures, fittings and/or appliances does not imply they are in full efficient working order as they have not been tested. All dimensions are approximate. Photographs are reproduced for general information and it cannot be inferred that any item shown is included in the sale. These Sales Particulars do not constitute a contract or part of a contract.
Came on the market: 19th February 2025

Viewer's Note:

Services connected: Gas, Electricity, Water, Drainage
Council tax band: A
Tenure: Freehold

Floor Plan

This floor plan is not drawn to scale and is for illustration purposes only

Ground Floor

Approx. 39.0 sq. metres (419.6 sq. feet)

Approx. 39.0 sq. metres (419.6 sq. feet)

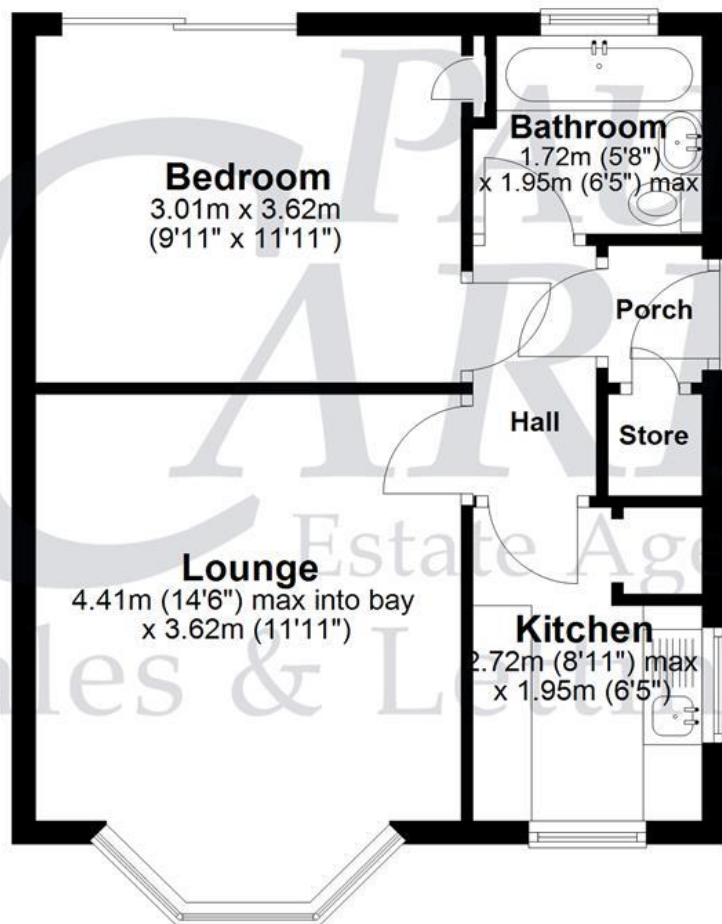

Energy Efficiency Rating

**New
Instruction
Awaiting
E.P.C.**

Map Location

